

Wednesday 9th April

	WZB					LV-BW	
Time	A 300	A 305	A 310	B 002/003	B 004/005	Saal	Württemberg
16:00 – 19:00			Governing Council				

Thursday 10th April

	WZB					LV-BW		
Time	A 300	A 305	A 310	B 002/003	B 004/005	Saal	Württemberg	
9:00 – 10:00			Governing Council	Life-long Learning Research Group, <i>Philip O'Connell</i>	ISCED Research Team, <i>Silke Schneider</i>			
10:00 – 12:00								
13:00 – 14:00			Governing Council					
14:00 – 16:00	INCDIS, <i>Chris Whelan</i>							
16:00 – 17:00			Children and Time Use in European Families, <i>Joris Ghysels</i>					
17:00 – 18:00		Equalsoc data support meeting, <i>Jane Roberts</i>						
18:00 – 19:00								

Friday 11th April

	WZB					LV-BW	
Time	A 300	A 305	A 310	B 002/003	B 004/005	Saal	Württemberg
	Session I (Plenary, Chair: Robert Erikson)						
8:00 – 9:00						Reception	
9:05 – 9:45						Allmendinger	
9:45 – 10:30						Atkinson	
10:30 – 11:00						<i>Coffee break</i>	
	Session II (Research group meetings)						
11:00 – 12:30	INCDIS, <i>Chris Whelan</i>		EDUC	TRALEG	SOCCULT, <i>Yannick Lemel</i>	EMPLOY, <i>Duncan Gallie</i>	FAMNET, <i>Chiara Saraceno</i>
12:30 – 13:30						<i>Lunch break</i>	
13:30 – 14:00						Introduction to the new website, <i>Monika Kaminska</i>	
	Session III (Group and team meetings)						
14:00 – 15:30	<i>Please see the programme for details.</i>						
15:30 – 16:00	<i>Coffee break (Lobby in part A of the building, 3rd floor)</i>					<i>Coffee break</i>	

Time	WZB					LV-BW	
	A 300	A 305	A 310	B 002/003	B 004/005	Saal	Württemberg
	Session IV (Semi-Plenary)						
	The inter-generational transmission of inequality (Chair: Louis-André Vallet)		The impact of globalisation on stratification processes and the importance of national versus European/ global boundaries (Chair: Jens Alber)			Educational systems, life long learning patterns and opportunities over the life course (Chair: Heike Solga)	Women's employment, fertility and social care arrangements: European diversities (Chair: Bea Cantillon)
16:00 – 16:30	Goldthorpe/Mills		Salverda			Schneider	Ozcan/ Esping-Andersen
16:30 – 17:00	Chauvel		Kahancova/ Visser/ Kaminska			Saar/ Roosma	Gonzalez/ Naldini
17:00 – 17:30	Tucci		Noelke			Stocké	Solera
17:30 – 18:00	Trumm/ Kutsar/ Kasearu		Whelan/ Maître			Schindler/ Reimer	Carriero/ Ghysels/ Vanklaveren
18:00 – 18:30	Lefranc		Sjöberg			Cebolla Boado	Mischke
19:30	<i>Conference dinner</i> (Abgeordnetenhaus Berlin, No. 5 on the map)						

Saturday 12th April

	WZB					LV-BW	
Time	A 300	A 305	A 310	B 002/003	B 004/005	Saal	Württemberg
	Session V (Semi-Plenary)						
	Educational systems, life long learning patterns and opportunities over the life course (Chair: Tony Fahey)		The impact of flexible labour markets on individual life courses and on the welfare state (Chair: Duncan Gallie)			Women's employment, fertility and social care arrangements: European diversities (Chair: Dobrinka Kostova)	Ethnicity, immigration and social inequality (Chair: Antonio Schizzerotto)
9:00 – 9:30	Barone		Esser			Nazio/ Saraceno	Demivera
9:30 – 10:00	Hällsten		van de Werfhorst/ Putman			Gähler/ Garriga	Kesler
10:00 – 10:30	Jacob/ Hillmert		Zou			van den Bosch	Fullin/ Reyneri
10:30 – 11:00	<i>Coffee break (Lobby in part A of the building, 3rd floor)</i>					<i>Coffee break</i>	

	WZB					LV-BW	
Time	A 300	A 305	A 310	B 002/003	B 004/005	Saal	Württemberg
	Session VI (Semi-Plenary)						
	The inter-generational transmission of inequality (Chair: Walter Müller)		The impact of flexible labour markets on individual life courses and on the welfare state (Chair: Michael Tåhlin)			Women's employment, fertility and social care arrangements: European diversities (Chair: Jonathan Gershuny)	Ethnicity, immigration and social inequality (Chair: Frank Kalter)
11:00 – 11:30	Erikson/ Torssander		Cooke/ Gash			Baizan	Kroneberg
11:30 – 12:00	Bihagen/ Nermo/ Stern		Halldén/ Zhou			Lapuerta/ Baizan/ Gonzalez	Brinbaum
12:00 – 12:30	Ebbinghaus/ Gronwald/ Wiss		Pochic			Schroeder/ Brüderl	Corluy/ Marx
12:30 – 13:00	Poggio					Wetzels	
13:00 – 14:00						<i>Lunch break</i>	

	WZB					LV-BW	
Time	A 300	A 305	A 310	B 002/003	B 004/005	Saal	Württemberg
	Session VII (Semi-Plenary)						
	The inter-generational transmission of inequality (Chair: Brian Nolan)		The impact of flexible labour markets on individual life courses and on the welfare state (Chair: Fran McGinnity)			Educational systems, life long learning patterns and opportunities over the life course (Chair: Herman van de Werfhorst)	
14:00 – 14:30	Salazar		Ortiz			Bernardi	
14:30 – 15:00	Goedeme		Arza			Checchi	
15:00 – 15:30	Lemel/ Coulangeon		Bozzon/ Barbieri			Boudesseul/ Grelet	
15:30 – 16:00						<i>Coffee break</i>	
	Session VIII (Plenary, Chair: Annemette Sorensen)						
16:00 – 16:45						Kogan	
16:45 – 17:30						Potucek	
17:30 – 18:15						Shavit	

Plans of the surroundings of the conference venues and of the WZB

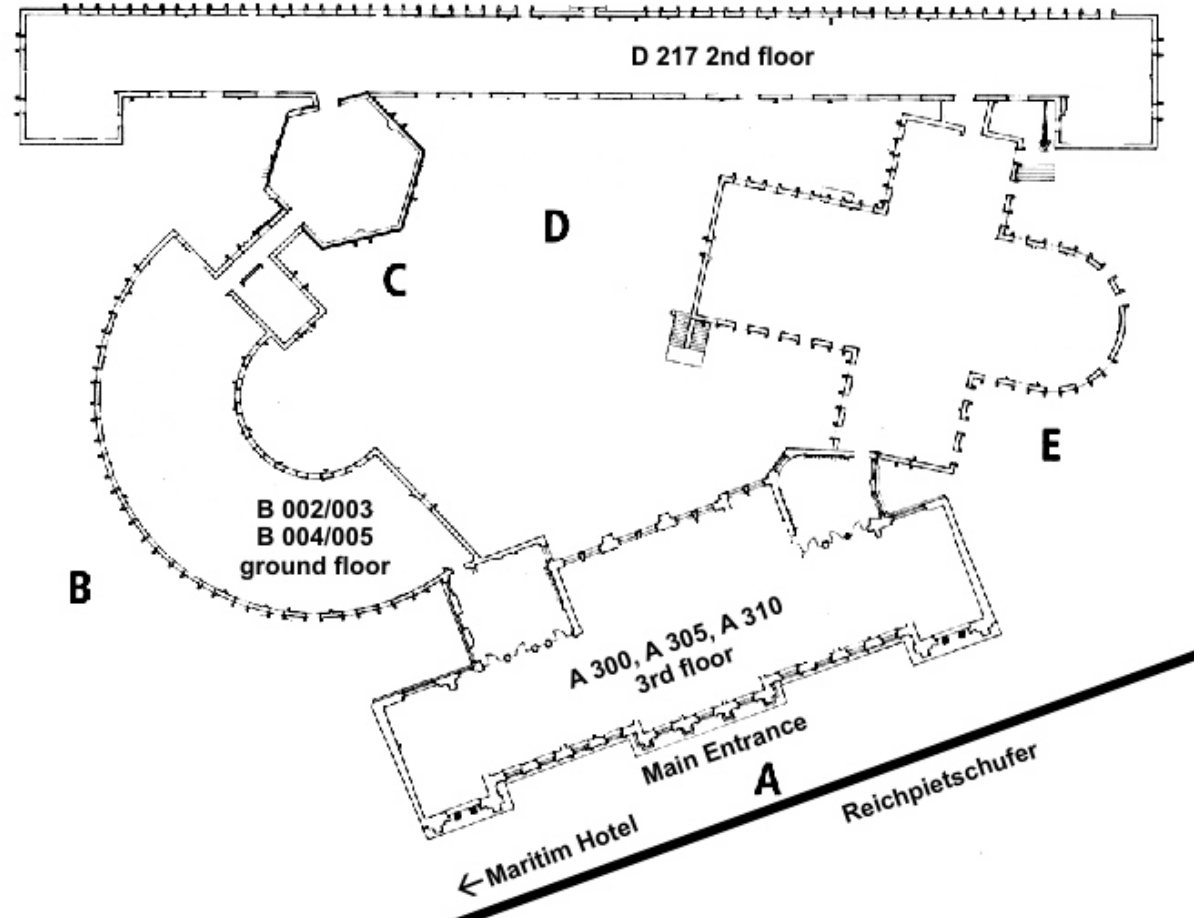
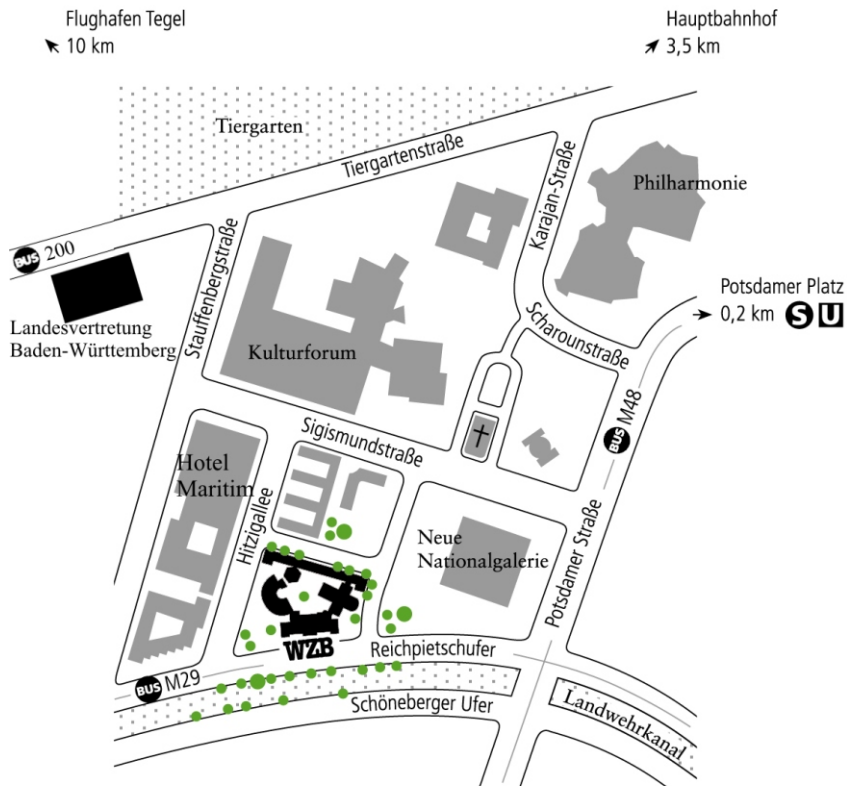

Landesvertretung Baden-Württemberg (LV - BW)

Conference Reception

Catering

Rooms:

*Saal, Württemberg, Hohenzollern, Kurpfalz,
Weinstube*

WZB

Rooms:

A 300, A 305, A 310, B 002/003, B 004/005, D 217

Flughafen Tempelhof
↗ 4 km

Flughafen Schönefeld
↘ 23 km